



SBWA Stream Clean-Up

Directions to Site 2

Site 2: Ken Lockwood Gorge – Lebanon Township – Hunterdon County

- **Location:** South Branch Raritan River at Ken Lockwood Gorge off of River Rd.
- **Special Note:** Areas to pick up trash: walk entire length of Gorge and along River Rd.
- **Driving Directions:**
31N – right onto 513N – go through High Bridge – pass Voorhees High School – right onto Hoffmans Crossing Rd – right after bridge onto River Rd – Ken Lockwood Gorge is just down the street.
- **Parking:** Parking lot at Ken Lockwood Gorge north access.
- **Trash Pick Up Location:** Intersection of Hoffmans Crossing Rd and River Rd. (Over bridge on left.)

Road map on reverse.



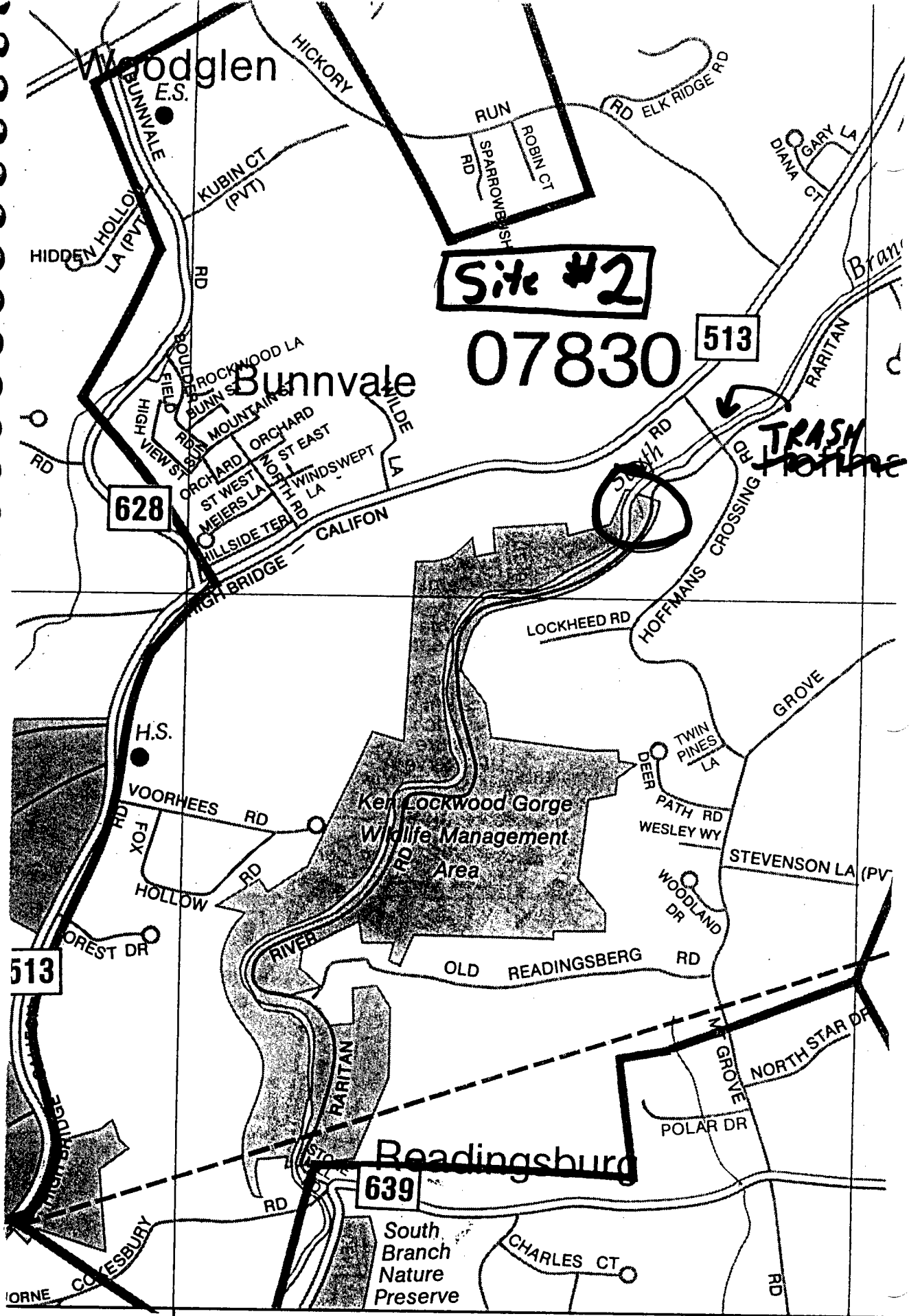

Site #2

07830

513

628

513

639

TRASH
POTLINE

M

FOR ADJOINING AREA SEE MAP